

Goessling USA, Inc.

Conveyors and Connecting Systems



Vertical Hopper Loader

for cold formed mass parts
blanks, screws, bolts, nuts
stamped parts
and others

to serve vibrating bowls
and other hoppers and
feeding units on threaders,
pointers and slotters,
pinch pointers, nut-tapping
and other machines



Our Vertical Hopper Loaders with gooseneck discharge operate on hinged steel belt types with specially designed running side plates to minimize gaps and prevent small or sharp pointed steel blanks or screws from working under the belt.

These part loaders increase productivity because of maintenance free design.

The feeding rate can be varied by a modern frequency controlled 3-phase gear motor with hollow shaft (no chain drive anymore!) in connection with automatic level sensing.

Belt width and discharge height depend on part sizes, capacity and infeed height of the machines to be served.

Our different deliverable types will meet all customer needs.

Ask for more details and your quotation.

Goessling design is known because of high quality.

Dimensions Vertical Hopper Loader (VHL)

belt width:	8", 10", 12", 14", 16", 20" 200, 250, 300, 350, 400, 500 mm
speed:	10, 12, 15 ft/min 5 to 30 ft/min infinitely variable
discharge height:	63" to 110" (1600 - 2800 mm)
electric drive:	electrical gear-motor 460 (420), 3-ph, 60 Hz option: frequency controller

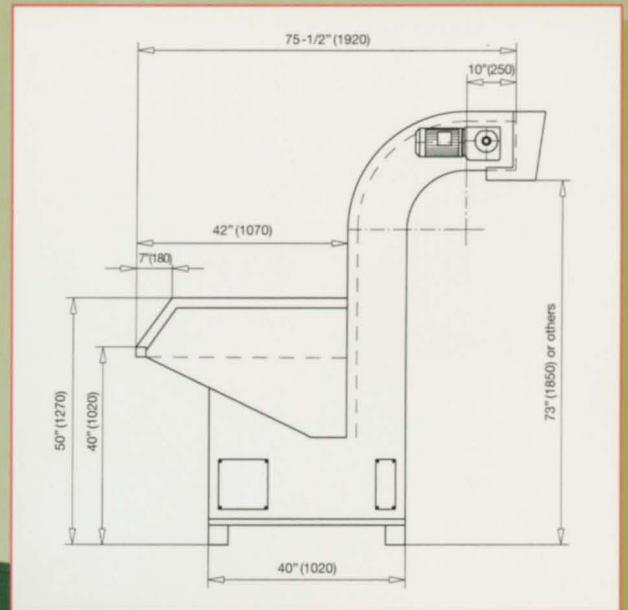
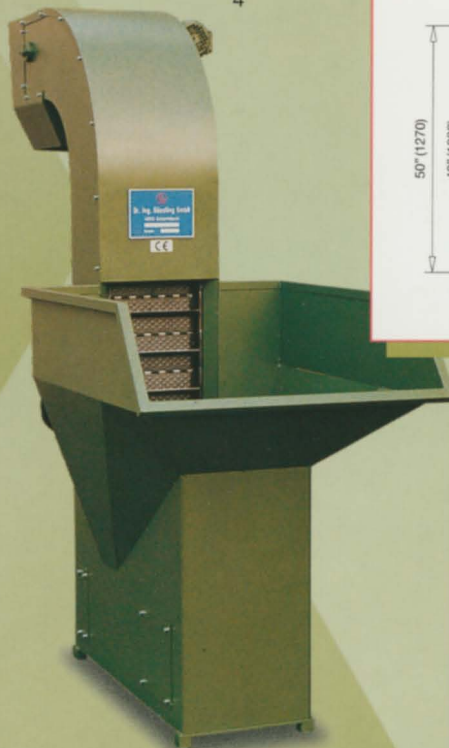

Goessling USA, Inc.

Conveyors and Connecting Systems

3308 Wayfield Drive
Johnson City, TN 37601
Phone: +1 (423) 915-0472 · Fax: +1 (423) 915-0839
e-mail: info@goesslingusa.com · www.goesslingusa.com

Goessling USA, Inc.
Convincing conveyor technology!